

Using the adapters the splitter can be connected between two IceBlast Hoses.

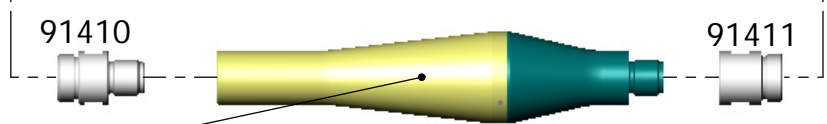

| Part nr. | Type          |
|----------|---------------|
| 91400    | 0.5-ø35-227.5 |
| 91401    | 1.0-ø35-227.5 |
| 91402    | 1.5-ø35-227.5 |
| 91403    | 2.0-ø35-227.5 |

**Possible attachments in between:**

Part nr.: 91201, 91203, 91205



| Part nr. | Type        |
|----------|-------------|
| 91101    | 5.1.72.128  |
| 91111    | 6.1.72.128  |
| 91121    | 7.1.72.128  |
| 91131    | 8.1.72.128  |
| 91141    | 9.1.72.128  |
| 91151    | 10.1.72.128 |

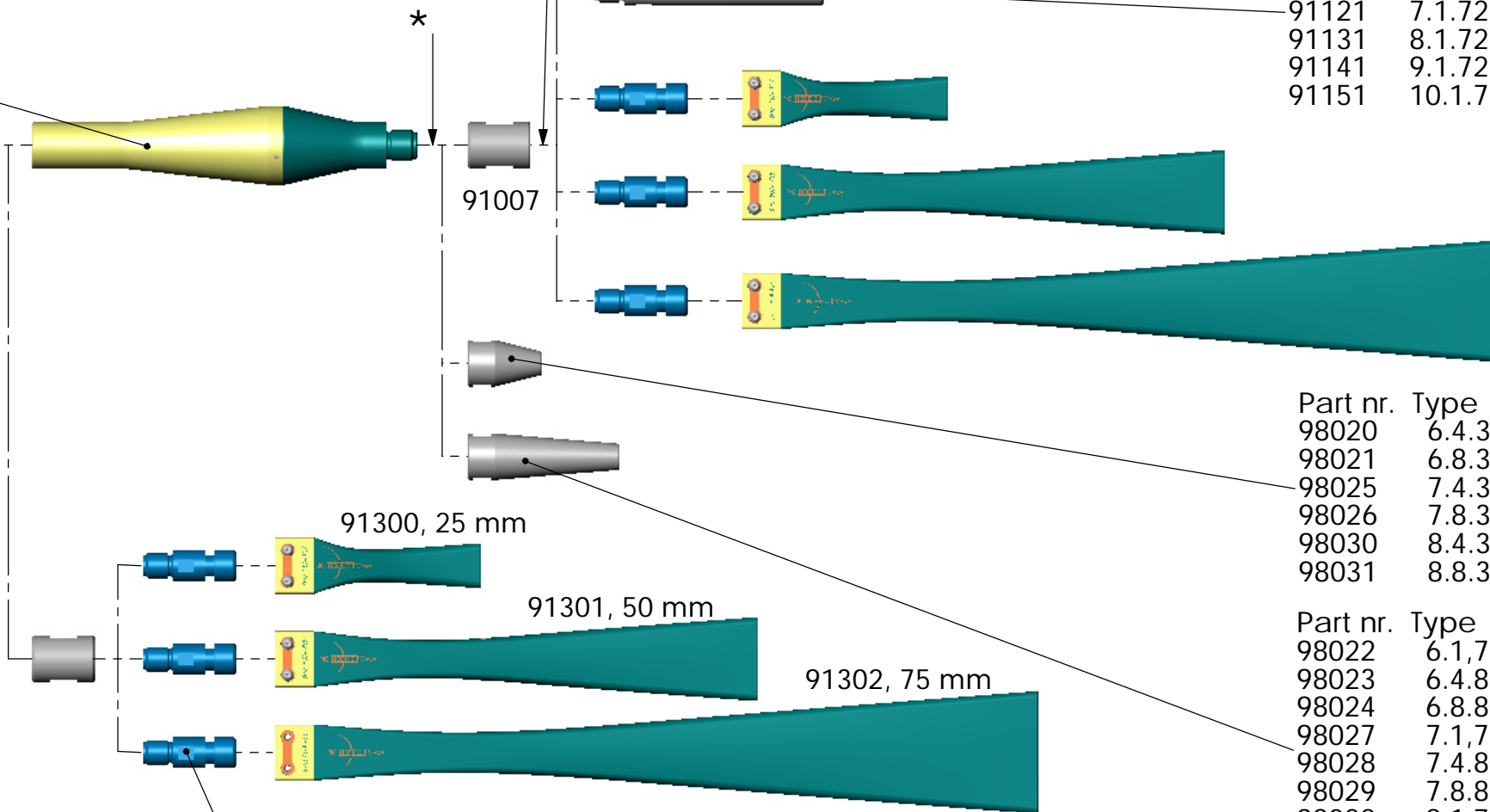

| Part nr. | Type   |
|----------|--------|
| 98020    | 6.4.30 |
| 98021    | 6.8.30 |
| 98025    | 7.4.30 |
| 98026    | 7.8.30 |
| 98030    | 8.4.30 |
| 98031    | 8.8.30 |

| Part nr. | Type      |
|----------|-----------|
| 98022    | 6.1,72.80 |
| 98023    | 6.4.80    |
| 98024    | 6.8.80    |
| 98027    | 7.1,72.80 |
| 98028    | 7.4.80    |
| 98029    | 7.8.80    |
| 98032    | 8.1,72.80 |
| 98033    | 8.4.80    |
| 98034    | 8.8.80    |

**\* Possible attachments in between:**

Part nr.: 90151



Part nr.: 98013, 98014, 98015



Part nr.: 91030, 91032, 91034



**Nozzle Inserts:**

| Part nr. | Type   |
|----------|--------|
| 91305    | ø.5-5  |
| 91306    | ø.6-5  |
| 91307    | ø.7-5  |
| 91308    | ø.8-5  |
| 91309    | ø.9-5  |
| 91310    | ø.10-5 |

|             |                                   |                                |         |        |   |
|-------------|-----------------------------------|--------------------------------|---------|--------|---|
|             | Dim. without tolerance ISO 2768-m | Chamfer without dim. 0,5 x 45° | Proj.   |        | <b>IceTech A/S</b><br>Industrivej 37 DK-6740 Bramming<br>Tel. +45 7656 1500 Fax. +45 7656 1509<br>WWW.ICETECH.DK - ICETECH@ICETECH.DK   |
|             | Material.                         |                                | CAD.    | SW     |   |
|             | Finish.                           |                                | Format. | A3     | <b>PROPRIETARY AND CONFIDENTIAL</b><br>THE INFORMATION CONTAINED IN THIS DRAWING IS THE SOLE PROPERTY OF ICETECH A/S. ANY REPRODUCTION IN PART OR AS A WHOLE WITHOUT THE WRITTEN PERMISSION OF ICETECH A/S IS PROHIBITED. |
|             | Comments.                         |                                | Scale.  | 1:4    |   |
|             |                                   |                                | Date.   | 020819 |   |
|             | Description.                      |                                | Sign.   | MJ     |   |
| A-020819-MJ | Correction.                       |                                | Rev.    | A      | Draw. No. 02081901-rev1   |

Assembly Drawing

Flat nozzle and splitter sortiment.  
Possible attachments with other components